

- Roads
- State & US
- County
- Local
- Sections (est.)
- City/Village
- Hydrants
- Streams & Rivers
- Municipal Boundary
- Inset Areas

TOWN OF REID



This map shows the approximate relative location of property boundaries but was not prepared by a professional land surveyor. This map is provided for informational purposes only and may not be sufficient or appropriate for legal, engineering, or surveying purposes. This is NOT a legal survey document!

Marathon County assumes NO legal responsibility for the accuracy of the information contained herein. This map is to be used for reference only!

Map Date: 4/22/2026

Path: O:\Common\gis\data\address_stuff\Uniform_Address_Maps\Address_Maps\Address_Maps.aprx

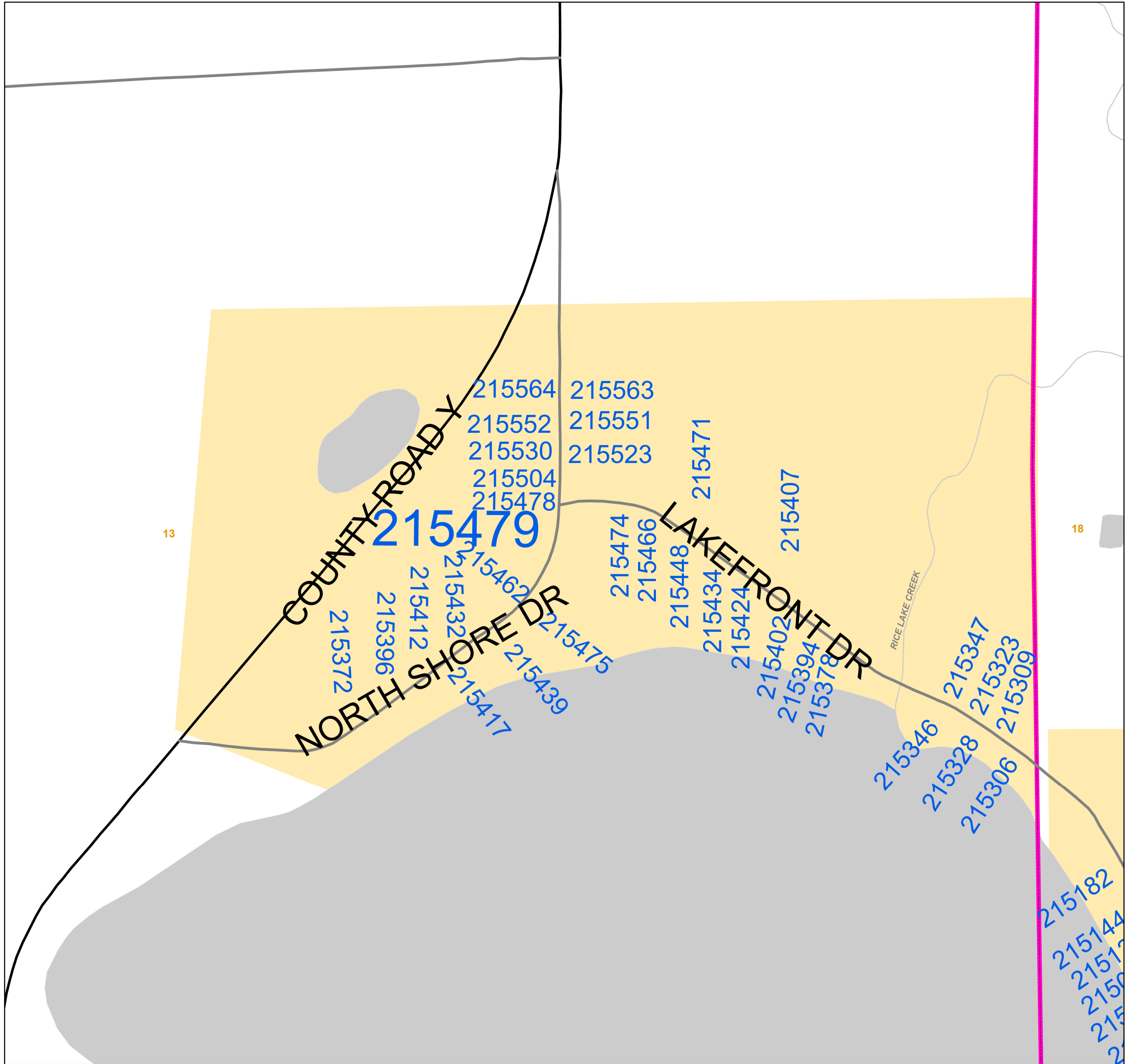

PIKE LAKE AREA

